

The Bearing & distance
down Delaware

- 1. 536 E. 44
 - 2. 517 E. 80
 - 3. 524 E. 42 3/4
-
- 166 3/4

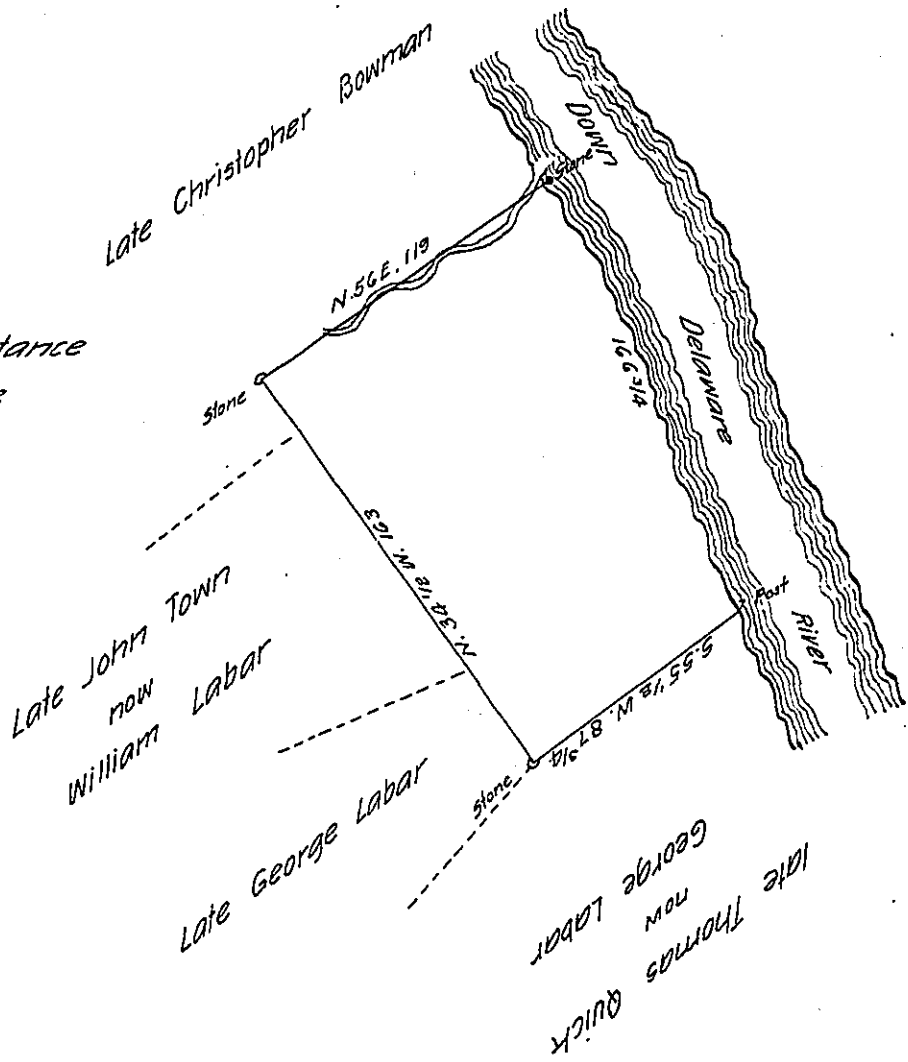

By virtue of a Warrant dated the 23^d December 1817. Surveyed
 the 5th January 1818 to George Labar Jun^r the above described Tract of land
 situate in Upper Mount Bethel township Northampton County. Containing One
 hundred two Acres and allowance of six p. Cent & c.

p. Geo. Palmer D. S.

To Richard T. Leech Esq^r }
 Surveyor General }

IN TESTIMONY that the above is a copy of the original remaining on file in
 the Department of Internal Affairs of Pennsylvania, made
 conformably to an Act of Assembly approved the 16th day of
 February, 1833, I have hereunto set my Hand and caused
 the Seal of said Department to be affixed at Harrisburg,
 this third day of October 1905

Loac R. Derrison
 Secretary of Internal Affairs.